

Wrights



28 Pavilions Court
Trowbridge BA14 0FY

Monthly Rental Of £865



Wrights Residential, 24 Fore Street , Trowbridge, BA14 8ER
Phone: 01225 755553, Email: enquiries@wrightsresidential.co.uk
www.wrightsresidential.co.uk

Spacious two bedroom apartment

First floor

Integrated white goods including dishwasher

Open plan living area

High quality bathroom with 4 piece suite

Two double bedrooms

Allocated parking for two vehicles

Unfurnished

This spacious two bedroom first floor apartment is situated on the outskirts of Trowbridge, close to Trowbridge retail park. Features include integrated white goods, open plan living area and a high quality bathroom with bath and separate shower enclosure. Further features include modern electric heating, double glazing and allocated parking for two vehicles. Available from late August, unfurnished.

The property comprises

Entrance Hallway

With wood laminate flooring and cupboard housing hot water cylinder and washer/dryer.

Open plan Kitchen/Living Room 17' 7" x 12' 5" (5.35m x 3.78m)

With wood laminate flooring, a range of eye level and base units, worktops with tiled splashbacks, integrate electric oven and ceramic hob with extractor hood over, integrated fridge/freezer and slimline dishwasher, one and a half bowl sink/drain unit, wall mounted modern electric heater and double glazed window to the rear aspect.

Bedroom 1 11' 8" x 11' 5" (3.55m x 3.47m)

With wall mounted modern electric heater and double glazed window to the rear aspect.

Bedroom 2 14' 1" x 8' 9" (4.28m x 2.67m) max

With wall mounted modern electric heater and double glazed window to the front.

Bathroom 7' 5" x 5' 10" (2.26m x 1.78m)

With tiled flooring, fully tiled walls, four piece suite comprising bath, shower enclosure with mains fed thermostatic shower with rain head and separate shower attachment, hand basin and W.C, heated towel rail, LED illuminated mirror and extractor fan.

Parking

This apartment comes with two allocated parking spaces and further visitor spaces.

Council tax

The property is in council tax band B.

Services

Mains electricity, water and drainage are connected. Please note that the Agent has not tested any appliances.



First Floor

Approx. 54.6 sq. metres (587.4 sq. feet)

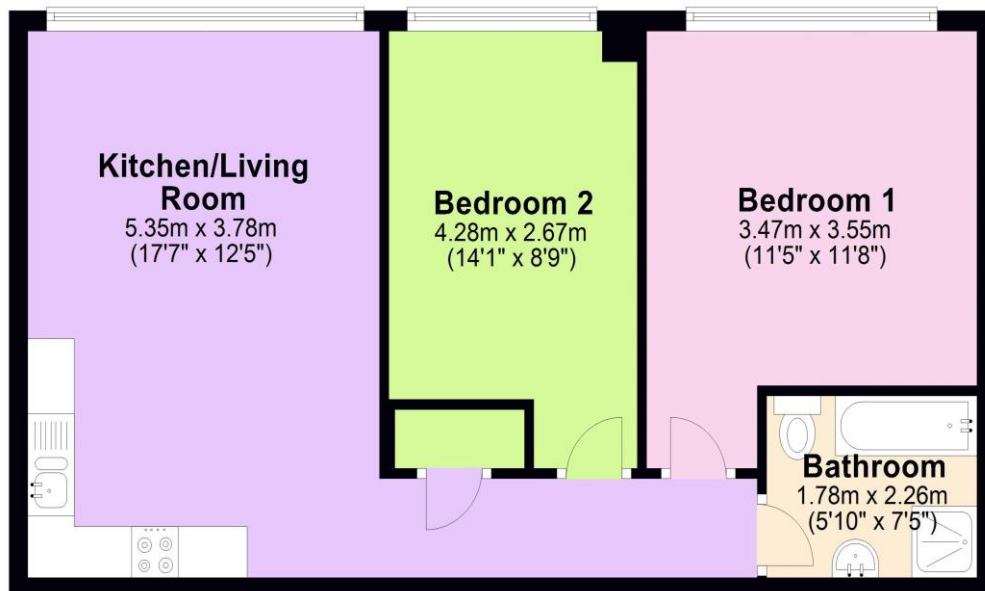

Total area: approx. 54.6 sq. metres (587.4 sq. feet)